

Whitechapel High Street

London • • E1 7RA
Per Month: £1,750 Per Month



coopers
est 1986

Whitechapel High Street

London • • E1 7RA

A one bedroom apartment set on the 1st floor of a converted building, located close to Aldgate East station and within easy reach of The City. On the edge of Shoreditch/Brick Lane area.

Features include a living room with wood flooring, and an open plan kitchen with breakfast bar and a bedroom with an integrated wardrobe.

Available mid October

1st floor

Wood flooring

Open plan living room/kitchen

Bedroom with integrated storage

Close to Aldgate East station

These particulars are intended as a guide and must not be relied upon as statements of fact. Your attention is drawn to the Important Notice on the last page.







Schools:

A one bedroom apartment set on the 1st floor of a converted building, located close to Aldgate East station and within easy reach of The City.



Train:



Car:

M4, A40, M25, M40



Council Tax Band:

B

(Distances are straight line measurements from centre of postcode)

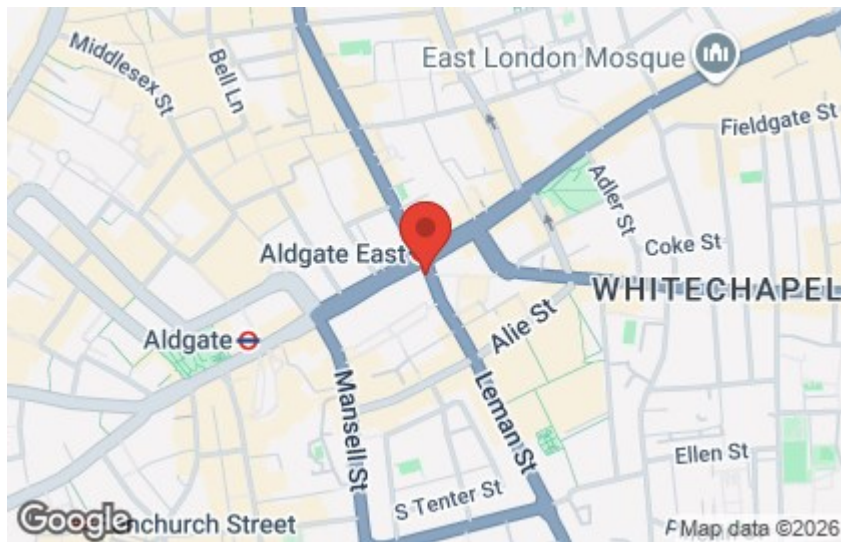

FIRST FLOOR 431 sq.ft. (40.0 sq.m.) approx.

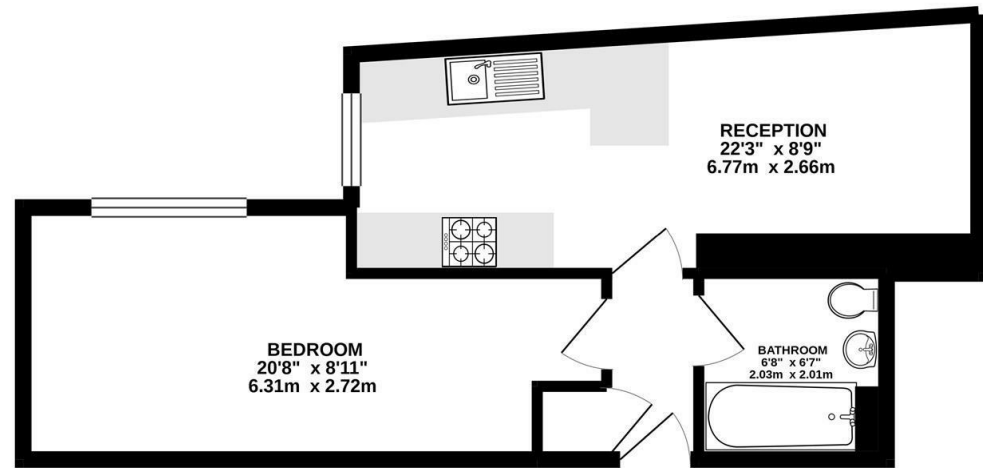

WHITECHAPEL HIGH STREET E1

TOTAL FLOOR AREA : 431 sq.ft. (40.0 sq.m.) approx.

Whilst every attempt has been made to ensure the accuracy of the floorplan contained here, measurements of doors, windows, rooms and any other items are approximate and no responsibility is taken for any error, omission or mis-statement. This plan is for illustrative purposes only and should be used as such by any prospective purchaser. The services, systems and appliances shown have not been tested and no guarantee as to their operability or efficiency can be given.
Made with Metropix ©2020



0207 580 9658

22 Cleveland Street, Fitzrovia,
London, W1T 4JB

info@coopersonlondon.co.uk

CoopersResidential.co.uk

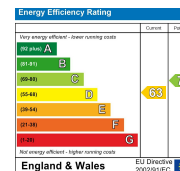

Important Notice: These particulars, whilst believed to be accurate are set out as a general outline only for guidance and do not constitute any part of an offer or contract. Intending purchasers should not rely on them as statements or representation of fact, but must satisfy themselves by inspection or otherwise has the authority to make or give any representation or warranty in respect of the property.